

Praying the



Stations OF THE CROSS

2024

Praying the Stations of the Cross

Not everyone has the means or opportunity to visit Israel and to retrace the path Jesus took as he journeyed from Gethsemane to the cross and tomb. Yet, taking time to reflect and pray while following the path Jesus took can enhance our Lenten and Easter worship. The Stations of the Cross provide an opportunity to follow the path Jesus took without the need for travel. The Stations of the Cross highlight fourteen key events in Jesus' journey. We have added a fifteenth station to allow participants to engage in an project that will be used in worship on Resurrection Sunday. Several slightly different versions of the Stations of the Cross have been developed. The one we are following was introduced by Pope John Paul II in 1991 and is known as the Scriptural Way of the Cross.

Participants are invited to visit and revisit the stations at your own pace, taking time to read and meditate on the scripture and theme for each station and to spend time in prayer before moving to the next station. The stations will be available March 17–March 29 from 1:00 pm–5:00 pm, with the exception of Saturday, March 23.

The Spiritual Formation Committee invites everyone to extend their spiritual pilgrimage by prayerfully walking the labyrinth, located behind the church. While the Stations of the Cross will only be available during Lent, the labyrinth is available year round and provides an opportunity to reflect on any of the journeys Jesus took during his life as well as the opportunity to imagine through a tangible activity that Jesus is walking beside you on your life's journey.

Thank you

The Spiritual Formation and Worship Committees would like to thank all the artists and poets who contributed to this journey for donating their time, talents, and resources. The Committees want to thank all those who provided food for the covered-dish lunch, attended the lunch or in any other way made this endeavor possible. Special thanks go to Keith Jameson and Mary Frances Thompson for the many hours they spent envisioning, planning, and communicating with the artists and poets about this endeavor.

Station 1

Jesus in the Garden of Gethsemane

Matthew 26:36-41

Prayer Prompt

What areas or circumstances in your life are you struggling to join Christ in praying “not what I want but what you want, Lord?” Where in your life is the spirit willing, but the flesh weak?

Pray for God to help you “let go” and surrender to His will.

Location

Narthex of Fellowship Hall
(Upper Level)

Artists

Bonnie and David Corbitt

Artist's Description of the Artwork:

Bonnie: “Always drawn to and mesmerized by vivid colors, this art form speaks to my heart as darkness falls and the sun rises. I love taking pieces of glass and creating a simple flower, a brilliant sunset, or a garden at night for prayer” David: ‘This cup is turned from spalted maple and reminds us of the cup that ‘Jesus prayed to be taken from him.”

Station 2

Jesus, Betrayed by Judas, Arrested

Mark 14:43-46

Prayer Prompt

Judas betrayed Jesus when Jesus did not fulfill Judas’ expectations of a Messiah.

As you pray, be honest with God. How has God not fulfilled your expectations?

Confess to God, the ways you have betrayed Him in order to fulfill your desires and your view of how the world should be?

Location

Parlor
(Upper Level)

Artist

Shirley Dominick

Artist's Description of the Artwork:

“After 50 years of painting and teaching painting, my “new” go to medium is watercolor. The subject was not a happy one, but pivotal in Jesus’ life and death. This assignment made me really think about what it means to follow Jesus.”

Station 3

Jesus Is Condemned by the Sanhedrin

Luke 22:66-71

Prayer Prompt

Jesus spent three years showing the religious leaders of his time that He was the Messiah, yet they questioned him. Who is Christ to you? What authority does Christ have in your life?

Ask God to help you become aware of the ways in which you question the authority and authenticity of Jesus.

Location

Chapel
(Upper Level)

Artists

Chancel Choir and
Sounds of Grace

Artists' Description of the Artwork

“The Chancel Choir and the *Sounds of Grace* have recorded two selections as an 'aural' Station of the Cross: "Depth of Mercy", music by Dwight Gustafson with words by Charles Wesley, and "Bless the Lord, O My Soul", music by Joe E. Park with words from Psalm 103.”

Station 4

Jesus Is Denied by Peter

Matthew 26:69-75

Prayer Prompt

Like Peter we want to think we would never deny Jesus, yet our words and actions often do just that. When have you denied Christ with your words or actions?

Confess to God times you have failed to claim Him as your friend and Savior.

Location

God's Backyard
(Lower Level)

Artists

Cheerful Cherubs
(Preschoolers)

Artists' Description of the Artwork

“Cherry Smith sketched out the rooster. We added color using the Cheerful Cherubs children's handprints for the tail, feet, comb, and beak. The teacher handprints were used for the body.”

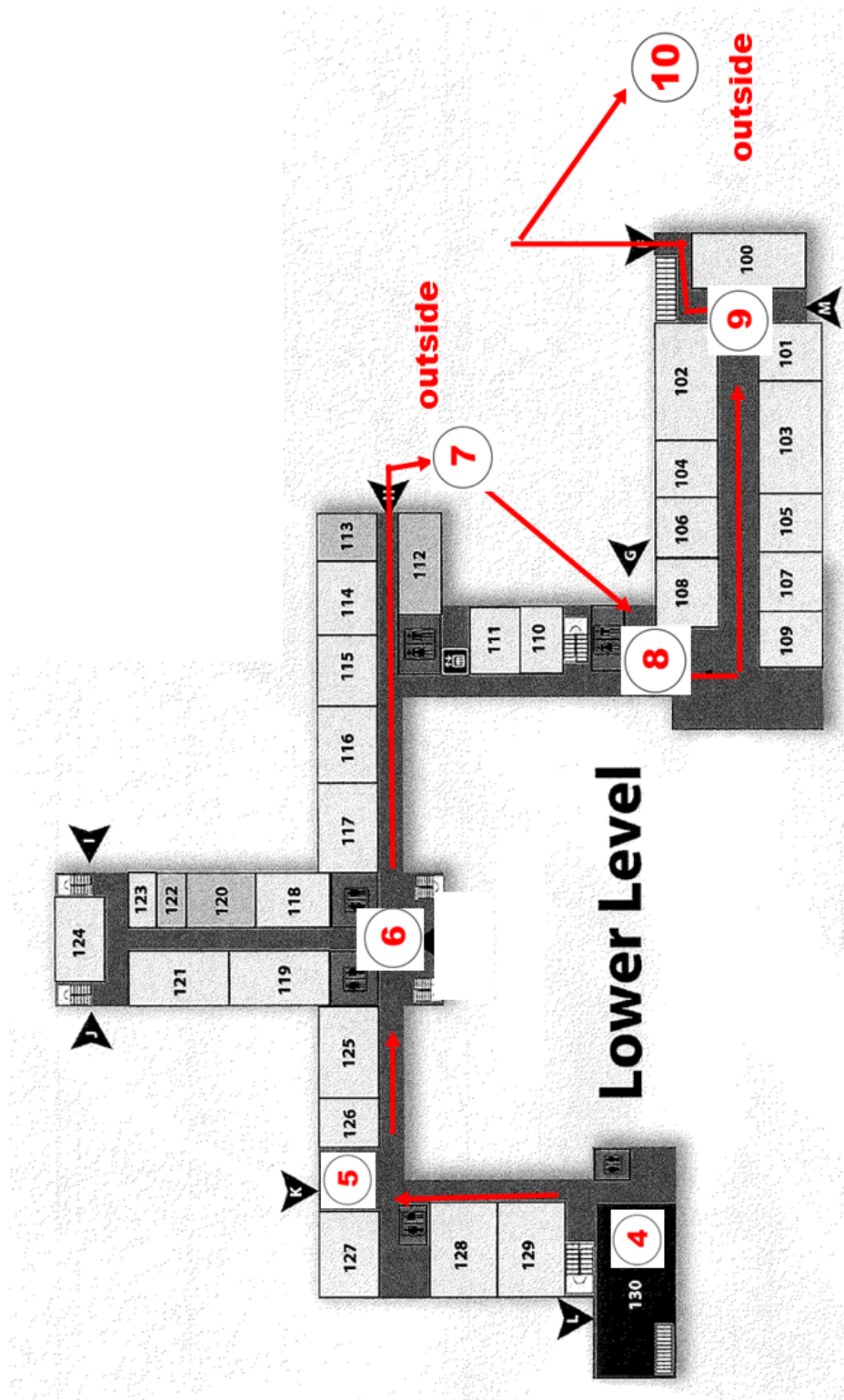

Station 7

Jesus Bears the Cross

John 19:6, 15-17

Prayer Prompt

The religious leaders incited the crowd and pledged their allegiance to Caesar and not God. How have others' emotions or opinions incited or influenced your allegiances or actions?

Pray for God to help you become aware of the ways that your allegiance belongs to someone or something other than God.

Location

Outside, Below Offices, Next to Lane Riley's Office (Lower Level)

Artists

Youth of First Baptist

Artists' Description of the Artwork

"This cross, recycled from a past FBC event, features a variety of recycled nails. FBC youth drove the nails into the cross as a reminder of the extreme pain and physical brutality that Jesus had to endure on the cross due to the nails in his hands and feet, the crown of thorns on his head, the spear in his side, and our sins piercing his heart."

Station 8

Jesus Is Helped by Simon, the Cyrenian, to Carry the Cross

Mark 15:21

Prayer Prompt

The religious leaders incited the crowd and pledged their allegiance to Caesar and not God. How have others' emotions or opinions incited or influenced your allegiances or actions?

Pray for God to help you become aware of the ways that your allegiance belongs to someone or something other than God.

Location

Gathering Space under the Sanctuary Narthex (Lower Level)

Artist

Summers Hall Reed (age 10)

Artist's Description of the Artwork

"I used acrylic paint and tried to make it very detailed. I feel sad that Jesus had to die on the cross, but am very thankful for Him."

Station 9

Jesus Meets the Women of Jerusalem

Luke 23:27-31

Prayer Prompt

The women were brave and were willing to approach Jesus on his journey to Calvary. Their tears reveal the anguish and empathy they felt for Christ, for themselves, and for their people. When have you empathized with the pain and suffering of others on their journey?

Pray for the women and children in the world who endure unfair treatment and abuse.

Location

End of Classroom Hallway, Near Handbell Room (Lower Level)

Artist

Keith Jameson

Artist's Description of the Artwork

"I had started a "Coronavirus" quilt during the pandemic, based on a website detailing how you could only use materials that you already had at home. For this project, I adapted it to create a "quilted stained-glass" panel depicting the women weeping as Jesus turns to bless them, as He walks by on the way to Golgotha. Materials are old shirts, sweaters, buttons, and khaki pants."

Station 10

Jesus Is Crucified

Luke 23:33-34

Prayer Prompt

Even in the midst of agony and pain, Jesus asks God to forgive those who abuse him. Who has caused you hurt or pain? Have you forgiven them? What holds you back? How difficult is it for you to ask God to forgive those who hurt you?

Ask God to help you forgive those who misunderstand and mistreat you.

Location

Outside on Hill Behind Sanctuary

Artist

Andy Westbrook

Artist's Description of the Artwork

"In many cultures, birds, such as doves, bluebirds, and cardinals, are seen as spiritual messengers. Birds are also seen as expressions of joy, peace and hope. In Luke 3:21-22 the dove stood for the third person of the blessed trinity. Perhaps the bird, while perched on the cross, can be a simple representation of our fellowship on the cross with Jesus. At the cross, everyone deserves a place in the presence of Jesus."

Station 11

Jesus Promises His Kingdom to the Good Thief

Luke 23:39-43

Prayer Prompt

One of the criminals, who is being crucified along with Jesus, recognizes Jesus' innocence and asks for Jesus to remember him. How have you asked others or God for forgiveness?

Thank Jesus that he forgives us and provides us a way for reconciliation with God, even though we don't desire his grace and mercy.

Location

Sanctuary (Upper Level)

Artist

Denise Waldrep

Artist's Description of the Artwork

"I have used mixed media to create this meditation on canvas about Christ's transforming power available for the thief and for us as well. . . ask, let go in order to receive, be made new."

Station 12

Jesus Speaks to His Mother and the Disciple

John 19:25b-27

Prayer Prompt

God's family is so wide and inclusive it goes beyond blood lines and biology. Who in your life has been like family to you even though you were not related? Who might need "family" to love and support them?

Thank God for people who are your "extended family" and ask God to show you persons who need your friendship and love, who need you to be their family even if they are not related to you biologically.

Location

Sanctuary Narthex (Upper Level)

Poet

Lee Wyndham

Poet's Description of the Artwork

"What was Mary thinking as she watched her son suffering on the cross? Did she have any idea that his dying was not the ending—only the beginning?"

Station 13

Jesus Dies on the Cross

Luke 23:44-46

Prayer Prompt

Even in our darkest moments God will not abandon us. When have you felt alone, afraid, or hopeless? Where was God in those moments?

Thank God for being with you and taking care of you in your darkest moments.

Location

Sanctuary Narthex
(Upper Level)

Artist: Bill Updegraff,
Sponsored by Anne Craig

Artist's Description of the Artwork

"See from His head, His hands,
His feet,
Sorrow and love pour
mingled down.
Did ere such love and sorrow meet
or thorns compose so rich a
crown?"

Station 14

Jesus, Is Placed in the Tomb

Matthew 27:57-60

Prayer Prompt

Joseph, a disciple of Jesus, takes his body and wraps it in clean linen cloth and lays Christ in the tomb. Joseph's heart like the hearts of the other disciples must have been full of grief. When have you felt overcome by grief? How have you ministered to others in their grief?

Pray for God to give you loving eyes to see and meet the needs of those who are grieving.

Location

Inner Room of Library
(Upper Level)

Artists

Paula and Robbie Boone

Artist's Description of the Artwork

"Our work is a collaborative effort, which includes a Celtic cross carved from Bubinga wood with a painted cabochon (shaped and polished gem stone) in the center, three hand painted votives and a mixed media piece with a haiku."

Prayer Prompt

We don't want to dwell on the events of Good Friday or the grief of Holy Saturday. We don't want to wait even three days for the resurrection. We need to wait. We need to grieve. We need to die to those things and attitudes that damage our relationship with God.

Ask God to use the days between now and Easter to cleanse and prepare your heart so you can renew your commitment to Jesus and celebrate and share the Good News of Easter.

Station 15

Jesus Is Risen

**Luke 24:1-9, Mark 16:1-7
Matthew 28:1-10, John 20:1-18**

Location:

Fellowship Hall
(Upper Level)

Artist

You

Description of the Artwork

Please contribute to the artwork in fellowship hall. An outline of a sunrise has been drawn. Various colors of tissue paper, scissors, and glue are available. Please add several pieces of tissue paper to the design. You may want to trace your hand, cut out the tracing, and add it to the picture. You may prefer to tear or cut pieces of tissue paper to add to the drawing. The tissue paper may be overlapped to create variations of the colors. We'd like as much color as possible added to the drawing. There is no right or wrong way to add the paper. We suggest that the space between sun rays be filled in with white, light yellow, pink, or blue tissue paper and that the dark paper be used for the sun and its rays. On Easter morning, the finished picture will be presented to the congregation as a part of the morning service.



722 Grace Street
Greenwood, SC 29649